



VOYAGE PLANNER

& FLEET GUIDE





EXPLORE

like never before



Explore the world like never before where luxury meets exploration, only with Seabourn. Discover new destinations off the beaten path. Immerse in local flavors through curated culinary experiences, like Shopping with the Chef, that connect you to the heart of each region. View wildlife and nature from the luxury of your private veranda or up close, guided by experts who bring the experience to life. Seabourn takes you beyond the expected. Where will you explore next?

CONTENTS

Featured Destinations	4
A World of Luxury with Seabourn	6
Voyage Planner At A Glance	8
Our Luxury Fleet	10
Seabourn Quest	12
Seabourn Ovation & Seabourn Encore	16
Seabourn Venture & Seabourn Pursuit	20



ALASKA

Discover Alaska's hidden gems found in diverse, remote ports and get closer to wildlife and nature than ever before with Seabourn. Our small-ship and optional *Ventures by Seabourn*® Zodiac® and kayak excursions provide deeper access to fjords, narrow inlets, and multiple glaciers— all guided by our masterful Expedition Team.



MEDITERRANEAN

Explore small-ship yacht harbors and boutique ports found off the beaten path and linger longer in port with itineraries curated for extended stays and overnights in marquee port favorites. Enjoy a magical evening exploring ancient Ephesus in Kuşadası, where Seabourn's exclusive cocktail party and private concert await in the Odeon theater.



ANTARCTICA

Step into the White Continent with up-close exploration on included Zodiac® cruises and onshore walks, guided by our world-class 23-person Expedition Team. Explore even further with optional kayak excursions, submarine dives, Image Masters photography program, and more.



JAPAN

Explore culinary and cultural hidden gems found in lesser traveled ports large ships cannot reach. Get an insider's look at a local market with a Seabourn chef as a guide, and choose from seasonal voyages during cherry blossom and plum blossom season or peak Fall foliage season.

OCEAN VOYAGES

Experience luxury like never before on *Seabourn Ovation*, *Seabourn Encore*, and *Seabourn Quest*, carrying just 450 to 600 guests with nearly one team member for every guest. Choose from hundreds of inspired, handcrafted voyages and oceans of options across all seven continents—from the Caribbean to the Mediterranean, New England to the South Pacific, Alaska to Northern Europe to Asia and beyond. Visit marquee cities, boutique ports, and hidden gems where larger ships cannot follow, enjoying countless *Seabourn Moments* along the way.



Scan the QR code to learn more about Seabourn's luxury Ocean Voyages.

EXPEDITIONS

Seabourn expeditions bring you up close to the wild and remote places of the world, perfectly combining bucket-list exploration with luxury comfort. *Seabourn Venture* and *Seabourn Pursuit* carry just 250 intrepid travelers to Antarctica, Arctic, the Kimberley, the South Pacific, and more — each expedition uniquely curated by Mother Nature, seasonal wildlife behavior, and our 23-person Expedition Team. You can be as active as you choose or enjoy incredible destination and wildlife experiences from the comfort of your private veranda or our expansive decks.



Scan the QR code to learn more about Seabourn's luxury Expeditions.



VOYAGE PLANNER AT A GLANCE

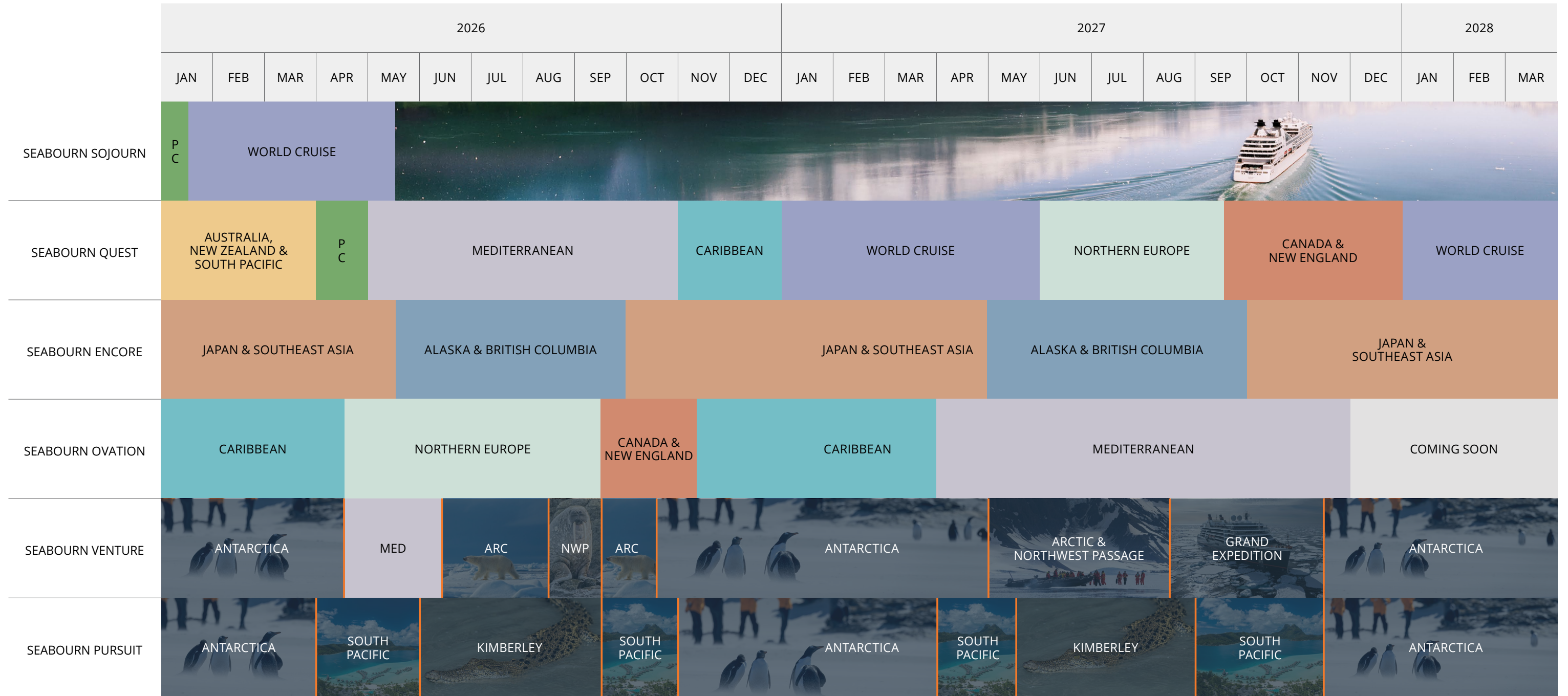

- NORTHERN EUROPE (NE)
- CANADA & NEW ENGLAND
- NORTHWEST PASSAGE EXPEDITIONS (NWP)
- ALASKA & BRITISH COLUMBIA
- ANTARCTICA EXPEDITIONS (ANT)
- CARIBBEAN
- JAPAN & SOUTHEAST ASIA
- KIMBERLEY EXPEDITIONS (KIM)
- PANAMA CANAL & HAWAII (PC)
- AUSTRALIA, NEW ZEALAND & SOUTH PACIFIC
- SOUTH PACIFIC EXPEDITIONS (SP)
- WORLD CRUISE
- ARCTIC & NORTHERN EUROPE EXPEDITIONS (ARC)
- GRAND EXPEDITION (GE)



OUR LUXURY FLEET

THE ULTIMATE ONBOARD EXPERIENCE

Immerse yourself in a world of refined luxury, world-class cuisine, and enriching activities.

SUITES

Thoughtfully designed and tastefully curated, our all-ocean-front suites feature expansive views, and Veranda suites open up to a private outdoor space for relaxing or entertaining. Chilled Champagne welcomes you along with amenities from a fully stocked bar to luxury products by Molton Brown, London. For even more space and elevated amenities, experience a Penthouse or Premium Suite.

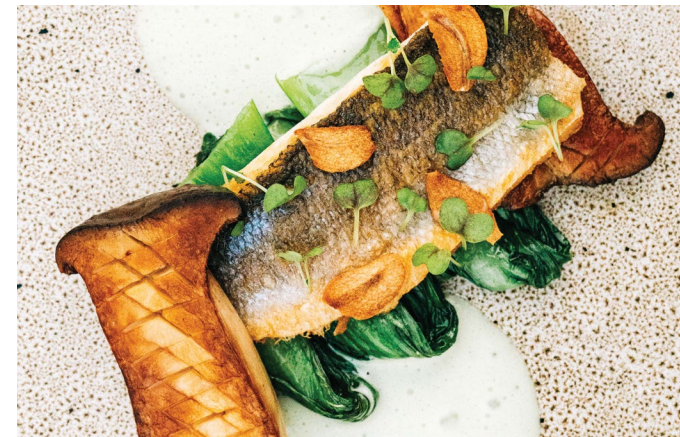

DINING

Our skilled chefs create award-winning cuisine in a wide range of settings to suit every mood and occasion. Choose from complimentary venues ranging from fine dining in The Restaurant or Solis to a relaxed setting at Sushi in The Club or Earth & Ocean at The Patio™, or indulge in our 24-hour in-suite dining featuring a varied menu of gourmet dishes.

ACTIVITIES

Engage with leading experts through *Seabourn Conversations*® featuring fascinating presentations and casual dialogues. Evenings offer diverse entertainment, from award-winning production shows and visiting guest entertainers to live music and poolside dancing. Visit the Casino or connect with fellow guests —curious, accomplished travelers who share similar worldviews.





GRAND WINTERGARDEN SUITE
DECK 7

GRWG (PREMIUM SUITE)

Combine suites 743 and 745 for suite 7435 or suites 744 and 746 for suite 7446.

Total space: 1,402 sq. ft. (130 sq.m.) including two verandas totaling 214 sq. ft. (20 sq.m.).

Large windows, dining for six, glass-enclosed solarium with tub and day bed, two bedrooms, two bathrooms (one whirlpool), guest bath, convertible sofa bed for one, pantry with wet bar, three closets and three flat-screen TVs.

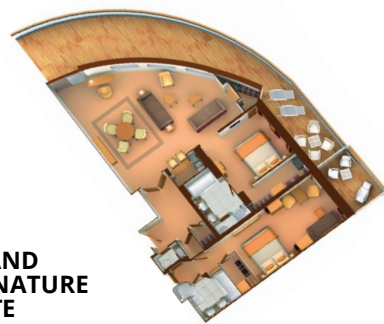

GRAND SIGNATURE SUITE
DECK 7

GRSS (PREMIUM SUITE)

Combine suites 700 and 702 for suite 7002 or suites 701 and 703 for suite 7013.

Total space: 1,904 sq. ft. including two verandas totaling 652 sq. ft. (61 sq.m.).

Expansive ocean views, forward-facing windows, dining for four to six, two bedrooms, two full bathrooms (one whirlpool), guest bath, pantry with wet bar, three closets and three flat-screen TVs.



WINTERGARDEN SUITE
DECK 7

WG (PREMIUM SUITE)

Suites 743 & 744.

Total space: 1,097 sq. ft. (102 sq.m.) including veranda of 183 sq. ft. (17 sq.m.).

Large windows, dining for six, whirlpool bathtub, guest bath, convertible sofa bed for one, pantry with wet bar, glass-enclosed solarium with tub and day bed, two closets and two flat-screen TVs.



PENTHOUSE SPA SUITE
DECK 10

PS

Suites 1090 and 1093.

Total space: 706 sq. ft. (66 sq.m.) including aft-facing veranda of 167 sq. ft. (16 sq.m.).

Suite 1091 and 1092

total space of 736 sq. ft. (69 sq.m.) including veranda of 200 sq. ft. (19 sq.m.).

Dining table for two to four, separate bedroom, glass door to veranda, walk-in closet, tub and spa shower, two flat-screen TVs. Penthouse spa suites do not have elevator access.

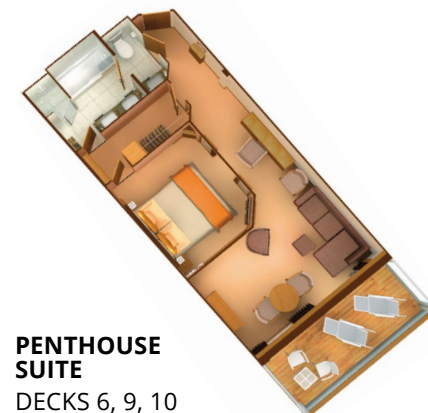

PENTHOUSE SUITE
DECKS 6, 9, 10

PH

Total space: 534 sq. ft. 9 (50 sq.m.) including veranda of 98 sq. ft. (9 sq.m.).

Dining table for two to four and separate bedroom with walk-in closet. Glass door to veranda, two flat-screen TVs. Deck 6 Suite 635 is larger and accessible, with tub and roll-in shower. Suite 1025 has a partially obstructed veranda view.



VERANDA SUITE
DECKS 5, 6, 7, 8, 9

V1 V2 V3 V4

Total space: 365 sq. ft. (34 sq.m.) including veranda of 65 sq. ft. (6 sq.m.).

Living area & queen-size or two twin beds, glass door to veranda, dining table for two, writing desk, makeup vanity, spacious bathroom with double vanities & separate shower & tub, walk-in closet.

Suites 745 and 746 interiors are 275 sq. ft. (26 sq.m.) with smaller verandas. Suites 924 and 1024 interiors are 286 sq. ft. (27 sq.m.). Dining table for two, living area and bedroom, glass door to veranda, walk-in closet and flat-screen TV.

The veranda railings in categories V3 to V6 are all glass from floor to teak rail. The railings in categories V1 and V2 are part metal and part glass from floor to teak rail.

Suites 502-507 have smaller verandas.

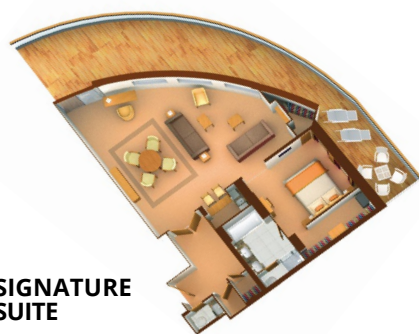

SIGNATURE SUITE
DECK 7

SS (PREMIUM SUITE)

Suites 700 & 701

Total space: 1,535 sq. ft. (143 sq.m.) including veranda of 587 sq. ft. (55 sq.m.).

Expansive ocean views, forward-facing windows, dining for four to six, whirlpool bathtub, guest bath, pantry with wet bar, two closets and two flat-screen TVs.

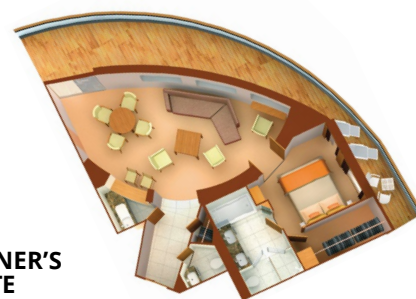

OWNER'S SUITE
DECKS 6, 7, 8

OW (PREMIUM SUITE)

Total space: between 602 sq.ft to 672 sq. ft. (56 - 62 sq.m.) including verandas between 143 and 383 sq. ft. (13 to 36 sq.m.).

Forward-facing windows, dining for four, separate bedroom, walk-in closet, guest bath, two flat-screen TVs, pantry with wet bar. Mid-ship suite 731 has a convertible sofa for one, whirlpool bathtub and no forward-facing windows. Suites 731, 600 & 601 have a different configuration.

Suites 600 and 601 are subject to noise when anchoring.



OCEAN VIEW SUITE
DECK 4

A A1

Total space: 295 sq. ft. (28 sq.m.)

Dining table for two, living area and bedroom, large picture window, walk-in closet and flat-screen TV.

Suites 410 and 413 are 283 sq.ft. (26 sq.m.). Suite 411 is 271 sq.ft. (25 sq.m.).

Diagrams are for illustration only. Actual suite configuration may vary. Sq.ft. and sq.m. amounts are approximations, and may vary.



PENTHOUSE SPA SUITE, SEABOURN QUEST

SHIP SPECIFICATIONS & FACILITIES

- 8 Dining Experiences
- Seabourn Square with coffee bar, library, business center, concierge & destination services
- 7 Lounges & Bars
- Spa & Salon
- Fully equipped fitness center
- 6 Outdoor whirlpools
- 2 Outdoor pools

CONNECTING SUITES

When combining the following suites, their suite numbers change as follows:

- 744 and 746 become Grand Wintergarden Suite 7446;
- 743 and 745 become Grand Wintergarden Suite 7435;
- 700 and 702 become Grand Signature Suite 7002;
- 701 and 703 become Grand Signature Suite 7013.

WHEELCHAIR ACCESSIBLE SUITES

Suites 408, 519, 619, 635, 715, 813 & 913 include roll-in shower only and wheelchair accessible doorways. Suite 635 also has a tub.

♣ Suites 600 and 601 are subject to noise when anchoring and the veranda railings are part metal and part glass from floor to teak rail

Δ Suite 828 third guest capacity for Seabourn Sojourn only

Δ Suite 830 third guest capacity for Seabourn Quest

▲ Third Guest Capacity Suite

E Elevator

☐ Self Service launderette

◆ Suites 502-507 and 745-746 have smaller verandas

■ Suite 1025 has a partially obstructed veranda view

♣ The veranda railings in category V1 is part metal and part glass from floor to teak rail

♣ Suites 1090, 1091, 1092, & 1093 are only accessible via a staircase

SUITE CATEGORIES

- GRWG Grand Wintergarden Suite
- WG Wintergarden Suite
- GRSS Grand Signature Suite
- SS Signature Suite
- O2 Owners Suite
- O1 Owners Suite
- PS Penthouse Spa Suite
- PH Penthouse Suite
- V4 Veranda Suite
- V3 Veranda Suite
- V2 Veranda Suite
- V1 Veranda Suite
- A1 Ocean View Suite
- A Ocean View Suite

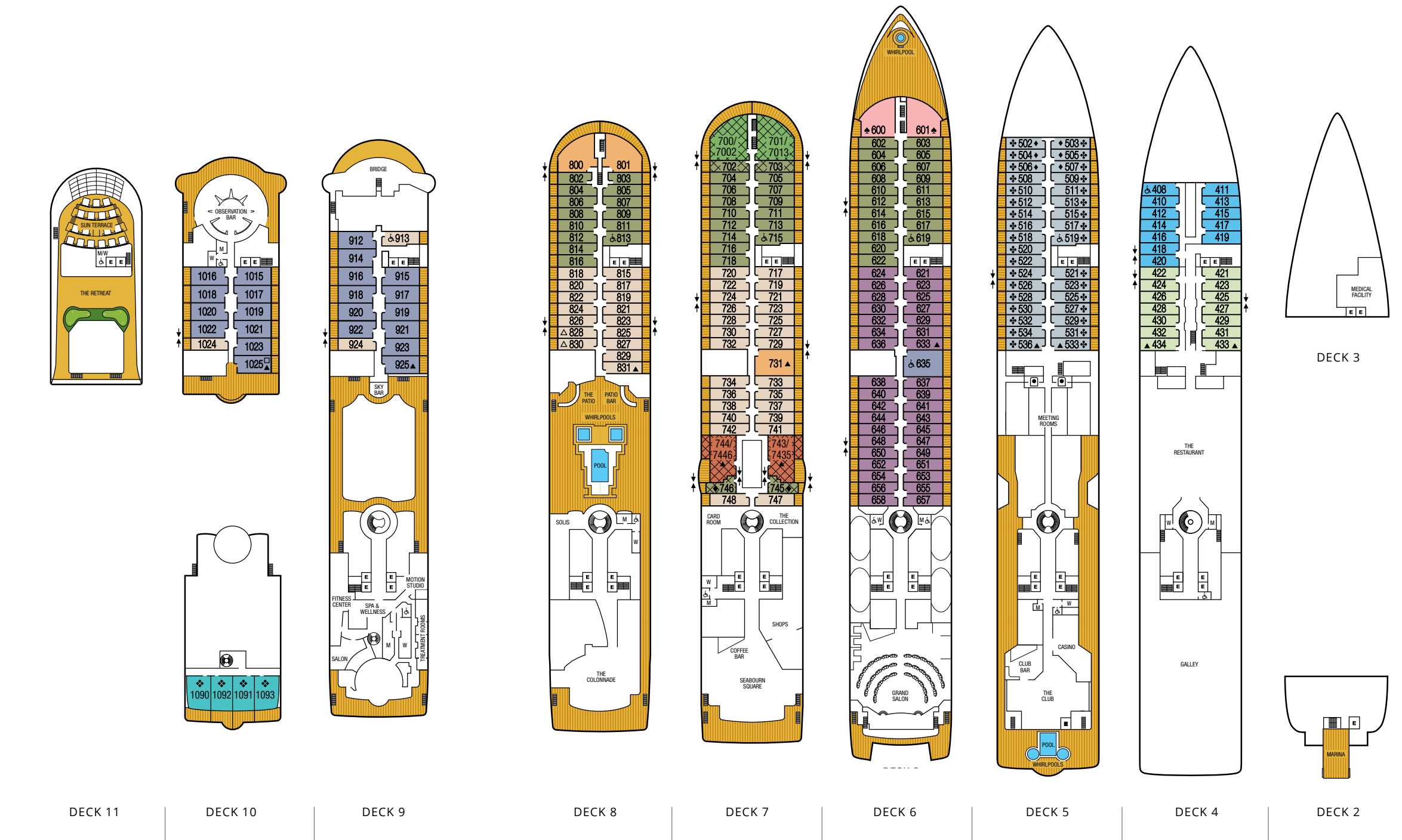

BUILT:
 Seabourn Sojourn – June 2010
 Seabourn Quest – June 2011
 Ships' registry: Bahamas
 Cruising speed: 19 Knots
 Gross tonnage: 32,000
 Guest capacity: 458

Length: 650 feet (198m)
 Beam: 84 feet (25.6m)
 Nationality of Officers, Staff & Crew: International
 Stabilizers: Yes
 Electric current: 110/220 AC

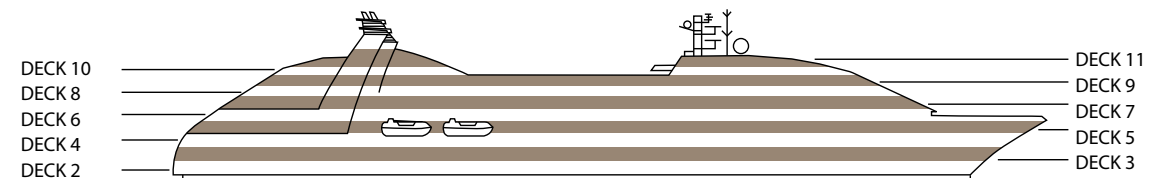

Deck plan is shown for illustration purposes. Seabourn reserves the right to make amendments and changes. For most current deck plans visit seabourn.com



GRAND WINTERGARDEN SUITE
DECK 8

GRWG (PREMIUM SUITE)

Combine suites 849 and 851 for suite 8491 or suites 746 and 848 for suite 8468.
Total space: 1,536 sq. ft. (143 sq.m.) including two verandas totaling 391 sq. ft. (36 sq.m.).

Large windows, dining for six, glass-enclosed solarium with tub and day bed, two bedrooms, two bathrooms (one whirlpool), guest bath, convertible sofa bed for one, pantry with wet bar, three closets and three flat-screen TVs.



GRAND SIGNATURE SUITE
DECK 8

GRSS (PREMIUM SUITE)

Combine suites 800 and 804 for suite 8004 or suites 801 and 805 for suite 8015.
Total space: 2,318 sq. ft. (215 sq.m.) including two verandas totaling 1,071 sq. ft. (99 sq.m.).

Large windows, dining for six, two bedrooms, two bathrooms (one whirlpool), guest bath, convertible sofa bed for one, pantry with wet bar, three closets and three flat-screen TVs.



WINTERGARDEN SUITE
DECK 8

WG (PREMIUM SUITE)

Suites 846 & 849.
Total space: 1,186 sq. ft. (110 sq.m.) including veranda of 197 sq. ft. (18 sq.m.).

Large windows, dining for six, whirlpool bathtub, guest bath, convertible sofa bed for one, pantry with wet bar, glass-enclosed solarium with tub and day bed, two closets and two flat-screen TVs.



OWNERS SUITE, SEABOURN ENCORE



SIGNATURE SUITE
DECK 8

SS (PREMIUM SUITE)

Suites 800 & 801.
Total space: 1,997 sq. ft. (186 sq.m.) including veranda of 1,000 sq. ft. (93 sq.m.).

Expansive ocean views, forward-facing windows, dining for four to six, whirlpool bathtub, guest bath, pantry with wet bar, two closets and two flat-screen TVs.



OWNER'S SUITE
DECKS 7, 8, 9 & 10

OW (PREMIUM SUITE)

Total space: between 588 to 606 sq. ft. (55 to 56 sq.m.) including veranda between 149 and 930 sq. ft. (14 to 86 sq.m.).

Forward-facing windows, dining for four, separate bedroom, walk-in closet, guest bath, two flat-screen TVs, pantry with wet bar. Mid-ship suites 742 & 838 have a convertible sofa for one, whirlpool bathtub and no forward-facing windows. Suites 700, 701 & 1012 have a different configuration. Suites 700 and 701 are subject to noise when anchoring.

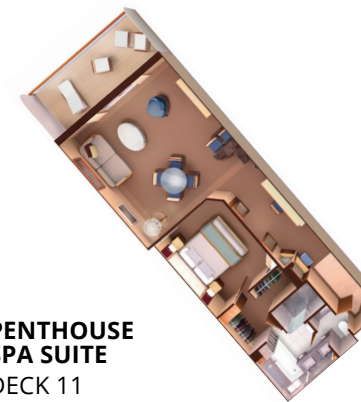

PENTHOUSE SPA SUITE
DECK 11

PS

Total space: between 653 to 691 sq. ft. (60 to 64 sq.m.) including aft-facing veranda between 260 to 294 sq. ft. (24 - 27 sq.m.).

Dining table for two to four, separate bedroom, glass door to veranda, walk-in closet, tub and spa shower, two flat-screen TVs.



PENTHOUSE SUITE
DECKS 10-11

PH

Total space: between 543 & 563 sq. ft. (51 & 60 sq.m.) including veranda between 93 and 103 sq. ft. (9 & 10 sq.m.).

Dining table for two to four and separate bedroom with walk-in closet. Glass door to veranda, two flat-screen TVs.



VERANDA SUITE
DECKS 5,6,7,8,9,10,11

V1 V2 V3 V4

Total space: between 319 to 382 sq. ft. (30 to 35 sq.m.) including veranda between 68 & 83 sq. ft. (6-7 sq.m.).

Dining table for two, living area and bedroom, glass door to veranda, walk-in closet and flat-screen TV. The veranda railings in categories V3 to V6 are all glass from floor to teak rail. The railings in categories V1 and V2 are part metal and part glass from floor to teak rail.

Diagrams are for illustration only. Actual suite configuration may vary. Sq.ft. and sq.m. amounts are approximations, and may vary.

SHIP SPECIFICATIONS & FACILITIES

- 9 Dining Experiences
- Seabourn Square with coffee bar, library, business center, concierge & destination services
- The Retreat
- 7 Lounges & Bars
- Spa & Salon
- Fully equipped fitness center
- 6 Outdoor whirlpools
- 2 Outdoor pools

CONNECTING SUITES

When combining the following suites, their suite numbers change as follows:

846 and 848 become Grand Wintergarden Suite 8468;
 849 and 851 become Grand Wintergarden Suite 8491; 800 and 804 become Grand Signature Suite 8004;
 801 and 805 become Grand Signature Suite 8015

Suites 850 and 852, and 853 and 855 connect on Seabourn Encore, but do not connect on Seabourn Ovation.

WHEELCHAIR ACCESSIBLE SUITES

Suites 550, 664, 665, 1012, 1132, 1191 include roll-in shower only, and wheelchair-accessible doorways.

Suites 700 and 701 are subject to noise when anchoring, and on Seabourn Encore have all metal veranda railings, limiting the view. On Seabourn Ovation the veranda railings are part metal and part glass from floor to teak rail.

The veranda railings on these suites are part metal and part glass. The forward half of the railing is metal and aft half is glass with teak rail.

Obstructed port side view with larger veranda overlooking the center pool on Seabourn Encore only.

Elevator

Self Service launderette

Third Guest Capacity Suite Sofa converts to the size of a twin bed to accommodate one guest.

Shower Only

The veranda railings on Deck 5 are part metal and part glass from floor to teak rail. Suites on Deck 5 have slightly larger verandas.

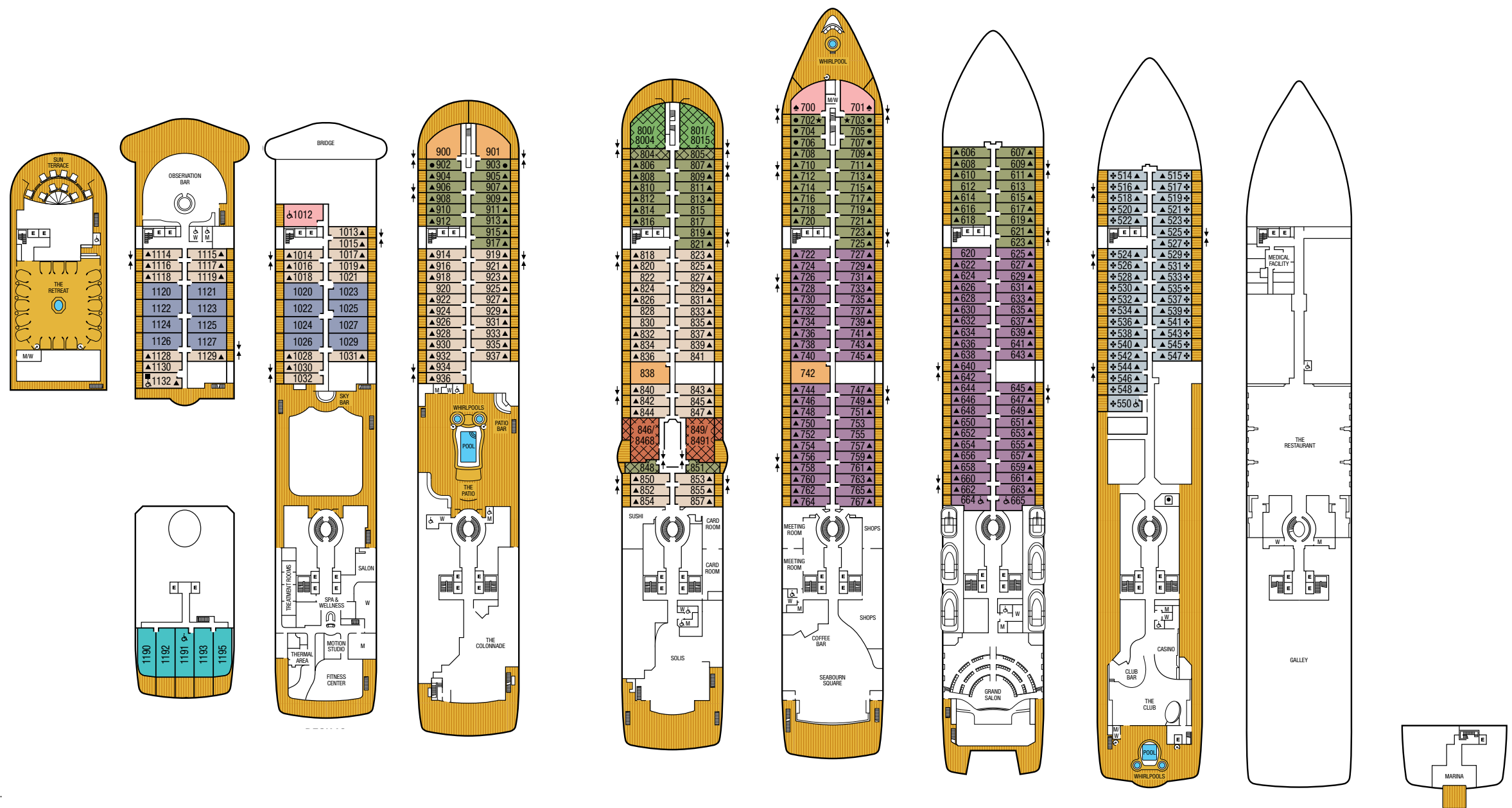

SUITE CATEGORIES

- GRWG Grand Wintergarden Suite
- WG Wintergarden Suite
- GRSS Grand Signature Suite
- SS Signature Suite
- O2 Owners Suite
- O1 Owners Suite
- PS Penthouse Spa Suite
- PH Penthouse Suite
- V4 Veranda Suite
- V3 Veranda Suite
- V2 Veranda Suite
- V1 Veranda Suite

BUILT:

Seabourn Encore – December 2016
 Seabourn Ovation – April 2018
 Ships' registry: Bahamas
 Cruising speed: 15 Knots
 Gross tonnage: 40,350
 Guest capacity: 600

Length: 690 feet (210m)
 Breadth: 92 feet (28m)
 Nationality of Officers, Staff & Crew: International
 Stabilizers: Yes
 Electric current: 110/220 AC

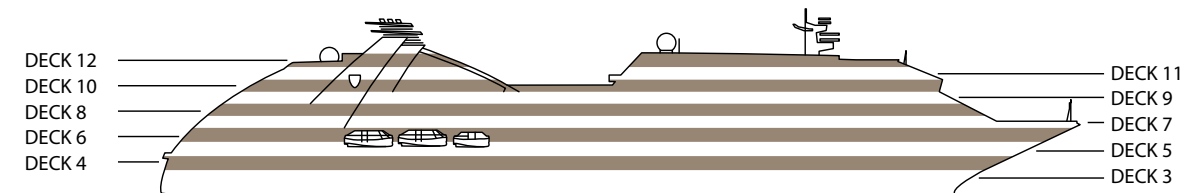

Deck plan is shown for illustration purposes. Seabourn reserves the right to make amendments and changes. For most current deck plans visit seabourn.com



LOWER FLOOR

GRAND WINTERGARDEN SUITE
DECK 7

GRWG (PREMIUM SUITE)

Combine mid-ship Suites 733 and 735 for Suite 7353, or Suites 734 and 736 for Suite 7364

Total space: 1,399 sq. ft. (130 sq.m.)
including two verandas totaling 205 sq. ft. (19 sq.m.).

Two level floor plan:

Lower: Dining tables for two and four, guest bath, large windows, glass doors to two verandas, pantry with wet bar, two separate living areas, second bedroom and bathroom with separate tub and shower, walk-in closet and personal heated wardrobe for expedition gear; writing desk; makeup vanity, stairway to:

Upper: Separate master bedroom, master bath with whirlpool spa tub and separate shower. An expansive wall of closets, a roll-up LG OLED TV and a tripod mounted Swarovski® ATX interior spotting scope.



UPPER FLOOR

LOWER FLOOR



UPPER FLOOR

WINTERGARDEN SUITE
DECK 7

WG (PREMIUM SUITE)

Suites 735, 736

Total space: 1,044 sq. ft. (97 sq.m.)
including veranda of 129 sq. ft. (12 sq.m.).

Two level floor plan:

Lower: Seating and dining for four, guest bath, large windows, glass door to veranda, pantry with wet bar, closet and personal heated wardrobe for expedition gear; writing desk; makeup vanity, stairway to:

Upper: Separate master bedroom, master bath with whirlpool tub and separate shower. An expansive wall of closets, a roll-up LG OLED TV and a tripod mounted Swarovski® ATX interior spotting scope.



SIGNATURE SUITE
DECK 8

SS (PREMIUM SUITE)

Suites 832, 833

Total space 1,377 sq. ft. (128 sq.m.)
including veranda of 592 sq. ft. (55 sq.m.).

Foyer entry to living area, dining table for four, guest bath, pantry with wet bar, large windows, glass door to large curved veranda with canopied whirlpool spa & sofa, separate bedroom with window, walk-in closet and personal heated wardrobe for expedition gear; writing desk; makeup vanity.



PENTHOUSE SUITE
DECKS 7 & 8

PH

Total space between 527 to 635 sq. ft. (49 to 59 sq.m.)
including veranda of 97 sq. ft. (9 sq.m.).

Living area with dining table for two, large windows, sliding glass door to veranda, separate bedroom with queen-size or two twin beds, bathroom with shower & tub, walk-in closet and personal heated wardrobe for expedition gear; writing desk; makeup vanity.

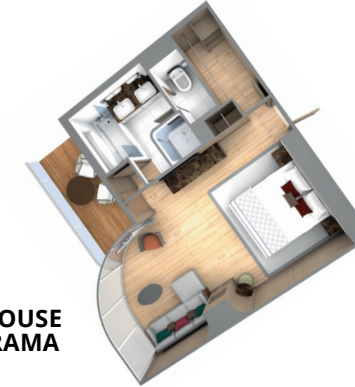

PENTHOUSE PANORAMA SUITE
DECKS 5, 6, 7 & 8

PA

Total space: 420 sq. ft. (39 sq.m.)
including veranda of 86 sq. ft. (8 sq.m.).

Sub-floor radiant heating throughout, seating area and curved panoramic windows, sleeping area with queen sized or two twin beds, dining table for two, glass door to veranda, walk-in closet and personal heated wardrobe for expedition gear; writing desk; makeup vanity. The bathroom features a separate shower and large soaking tub next to a window providing relaxing scenic views.

Total space: 355 sq. ft. (33 sq. m.)
including veranda of 78 sq. ft. (7 sq. m.)

Seating area with coffee/dining table for two, queen-size or two twin beds, sliding glass door to veranda, bathroom with separate shower and tub, walk-in closet and personal heated wardrobe for expedition gear; writing desk; makeup vanity.

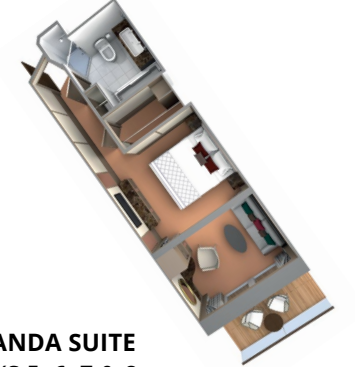

VERANDA SUITE
DECKS 5, 6, 7 & 8

V1 V2 V3 V4

Total space: 355 sq. ft. (33 sq.m.)
including veranda of 78 sq. ft. (7 sq. m.)

Seating area with coffee/dining table for two, queen-size or two twin beds, sliding glass door to veranda, bathroom with separate shower and tub, walk-in closet and personal heated wardrobe for expedition gear; writing desk; makeup vanity.



OWNER'S SUITE
DECK 7

OW (PREMIUM SUITE)

Suites 700, 701

Total space: 1,023 sq. ft. (95 sq.m.)
including veranda of 484 sq. ft. (45 sq.m.).

Living area, dining table for two to four, separate bedroom, large forward-facing windows, glass door to curved veranda with table for four, walk-in closet and personal heated wardrobe for expedition gear; writing desk; makeup vanity.



SIGNATURE SUITE, SEABOURN VENTURE

Diagrams are for illustration only. Actual suite configuration may vary. Sq.ft. and sq.m. amounts are approximations, and may vary.

SHIP SPECIFICATIONS & FACILITIES

- 8 Dining Experiences
- 24-hour in-suite room service
- Seabourn Square with coffee, bar, library, business center & concierge
- 8 Lounges & Bars
- Spa & Salon
- Fully equipped fitness center
- 4 Outdoor whirlpools
- 1 Outdoor Infinity pool

CONNECTING SUITES

When combining the following suites, their suite numbers change as follows:

Suites 733 and 735 become Grand Wintergarden Suite 7353; Suites 734 and 736 become Grand Wintergarden Suite 7364

WHEELCHAIR ACCESSIBLE SUITES

Suites 737, 738, 800, 824 and 825 include ADA shower only and wheelchair-accessible doorways.

Third Guest Capacity Suite

Sofa converts to the size of a twin bed to accommodate one guest.

Elevator

Self Service launderette

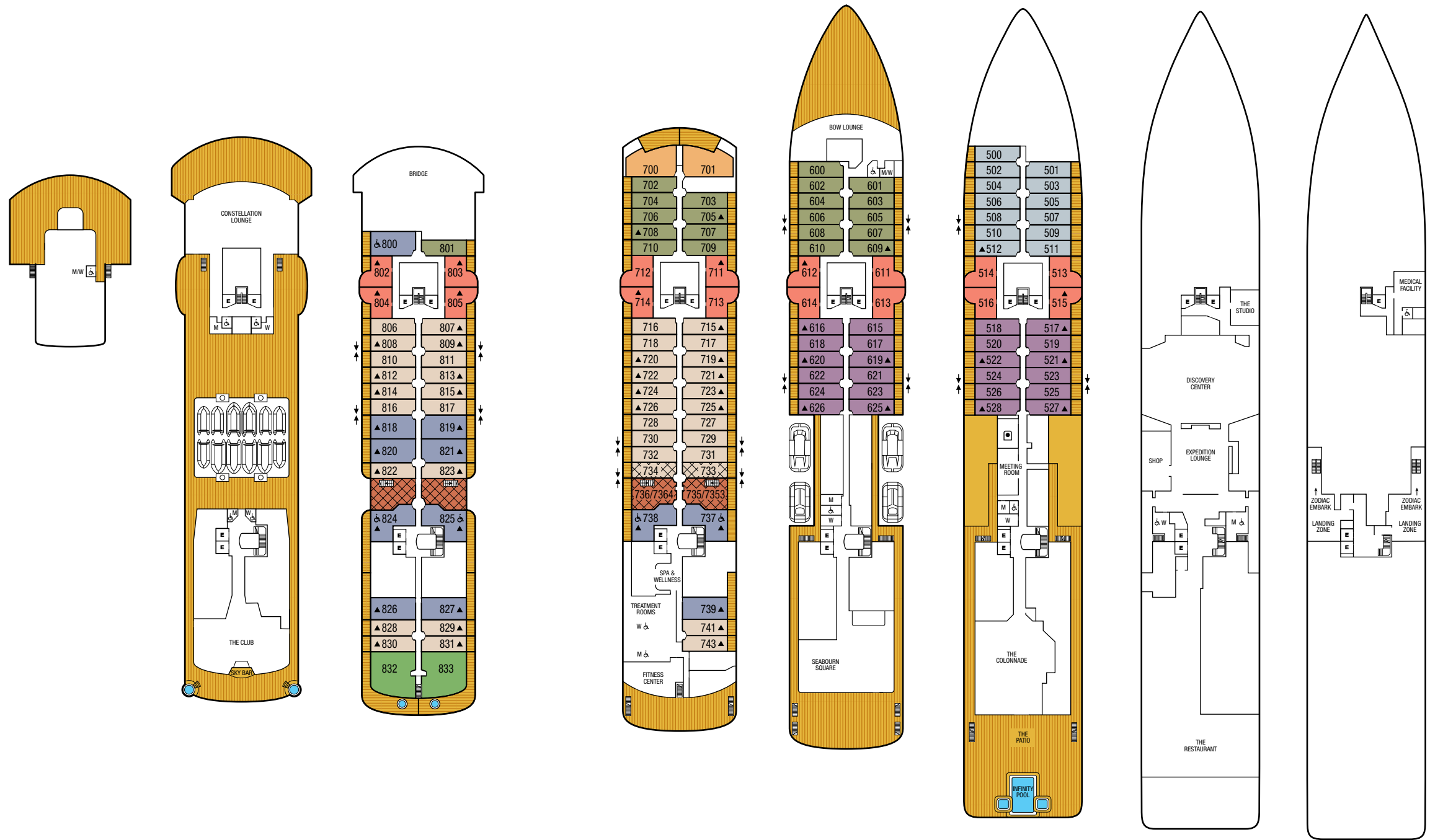

SUITE CATEGORIES

- GRWG Grand Wintergarden Suite
- WG Wintergarden Suite
- SS Signature Suite
- OW Owner's Suite
- PA Penthouse Panorama Suite
- PH Penthouse Suite
- V4 Veranda Suite
- V3 Veranda Suite
- V2 Veranda Suite
- V1 Veranda Suite

BUILT:

Seabourn Venture: July 2022
 Seabourn Pursuit: August 2023
 Ships' registry: Bahamas
 Hull: Polar Class 6
 Cruising speed: 18 Knots
 Gross tonnage: 23,000
 Guest capacity: 264

Length: 558 feet (170 m)
 Beam: 79 feet (24 m)
 Nationality of Officers, Staff & Crew: International
 Stabilizers: Yes
 Propulsion: 2 Azipods®
 Electric current: 110/220 AC

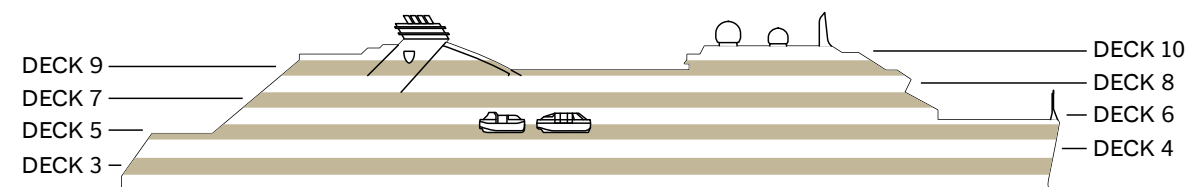

Deck plan is shown for illustration purposes. Seabourn reserves the right to make amendments and changes. For most current deck plans visit seabourn.com

THE SEABOURN ALL-INCLUSIVE DIFFERENCE

- Intimate ships with a private yacht-like atmosphere
- All ocean-front suites luxuriously appointed
- Intuitive, personalized service
- Complimentary premium spirits and fine wines
- Complimentary caviar
- World-class dining and culinary experiences
- All dining venues are complimentary
- Welcome Champagne and complimentary in-suite bar
- Tipping is neither required, nor expected
- Seabourn Conversations, connecting with visionary experts
- Curated voyages to all seven continents
- Ventures by Seabourn®, optional shore excursions*^
- Complimentary entertainment experiences
- Complimentary Wi-Fi packages with unlimited minutes
- Complimentary Signature Events
- Committed to environmental stewardship and sustainability



Ships' registry: Bahamas. ©2025 Seabourn